



An agency of the Government of Ontario



Un organisme du gouvernement de l'Ontario

This document was retrieved from the Ontario Heritage Act e-Register, which is accessible through the website of the Ontario Heritage Trust at **www.heritagetrust.on.ca**.

Ce document est tiré du registre électronique, tenu aux fins de la *Loi sur le patrimoine de l'Ontario*, accessible à partir du site Web de la Fiducie du patrimoine ontarien sur **www.heritagetrust.on.ca**.



City Clerk's Office

Ulli S. Watkiss
City Clerk

Secretariat
Rosalind Dyers
Toronto and East York Community Council
City Hall, 2nd Floor, West
100 Queen Street West
Toronto, Ontario M5H 2N2

Tel: 416-392-7033
Fax: 416-397-0111
e-mail: teycc@toronto.ca
Web: www.toronto.ca

ONTARIO HERITAGE TRUST

MAY 01 2009

RECEIVED

MAY 04 2009
Culture Programs & Services Branch
Culture Services Unit

**IN THE MATTER OF THE ONTARIO HERITAGE ACT
R.S.O. 1990 CHAPTER 0.18 AND
2 STRACHAN AVENUE (AUTOMOTIVE BUILDING)
CITY OF TORONTO, PROVINCE OF ONTARIO**

NOTICE OF PASSING OF BY-LAW

The Board of Governors of Exhibition Place
200 Princes' Boulevard
Toronto, Ontario
M6K 3C3
Att: Dianne Young, CEO and General Manager

Ontario Heritage Trust
10 Adelaide Street East
Toronto, Ontario
M5C 1J3

Take notice that the Council of the City of Toronto has passed By-law No. 392-2009 to designate 2 Strachan Avenue (Automotive Building) (Trinity-Spadina, Ward 19) as being of cultural heritage value or interest.

Dated at Toronto this 30th day of April, 2009.

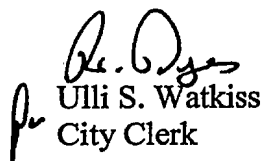
Ulli S. Watkiss
City Clerk

Authority: Toronto and East York Community Council Item 13.5,
as adopted by City of Toronto Council on March 3, 4 and 5, 2008
Enacted by Council: April 6, 2009

CITY OF TORONTO

BY-LAW No. 392-2009

To designate the property at 2 Strachan Avenue (Automotive Building) as being of cultural heritage value or interest.

WHEREAS authority was granted by Council to designate the property at 2 Strachan Avenue (Automotive Building) as being of cultural heritage value or interest; and

WHEREAS the *Ontario Heritage Act* authorizes the Council of a municipality to enact by-laws to designate real property, including all the buildings and structures thereon, to be of cultural heritage value or interest; and

WHEREAS the Council of the City of Toronto has caused to be served upon the owners of the land and premises known as 2 Strachan Avenue and upon the Ontario Heritage Trust, Notice of Intention to designate the property and has caused the Notice of Intention to be posted on the City's web site for a period of 30 days in accordance with Municipal Code Chapter 162, Notice, Public, Article II, § 162-4, Notice requirements under the *Ontario Heritage Act*; and

WHEREAS the reasons for designation are set out in Schedule "A" to this by-law; and

WHEREAS no notice of objection was served upon the Clerk of the municipality;

The Council of the City of Toronto HEREBY ENACTS as follows:

1. The property at 2 Strachan Avenue, more particularly described in Schedule "B" and shown on Schedule "C" attached to this by-law, is designated as being of cultural heritage value or interest.
2. The City Solicitor is authorized to cause a copy of this by-law to be registered against the property described in Schedule "B" to this by-law in the proper Land Registry Office.
3. The City Clerk is authorized to cause a copy of this by-law to be served upon the owners of the property at 2 Strachan Avenue and upon the Ontario Heritage Trust and to cause notice of this by-law to be posted on the City's web site for a period of 30 days in accordance with Municipal Code Chapter 162, Notice, Public, Article II, § 162-4, Notice requirements under the *Ontario Heritage Act*.

ENACTED AND PASSED this 6th day of April, A.D. 2009.

SANDRA BUSSIN,
Speaker

ULLI S. WATKISS
City Clerk

(Corporate Seal)

SCHEDULE "A"**REASONS FOR DESIGNATION**Description

The property at 2 Strachan Avenue (Automotive Building) is worthy of designation under Part IV, Section 29 of the *Ontario Heritage Act* for its cultural heritage value, and meets the criteria for municipal designation prescribed by the Province of Ontario under the three categories of design, associative and contextual value. Located at the east end of Exhibition Place, the Automotive Building was completed in 1929 as an exhibition hall for the display of automobiles and automotive products. The property was listed on the inaugural City of Toronto Inventory of Heritage Properties in 1973.

Statement of Cultural Heritage Value

The Automotive Building at Exhibition Place has design value as an excellent example of Modern Classicism with Art Deco detailing from the era between World Wars I and II. Its design was described in contemporary periodicals as a harmonization of Classical principles with Modernity (RAIC Journal, November 1929, 405). The Automotive Building represented the transition from the Beaux-Arts inspired structures at the west and east ends of the site (including the adjoining Princes' Gates) to those of the next decade with their application of Art Moderne and Art Deco stylistic features (Horse Palace, 1931 and Bandshell, 1936).

The Automotive Building is associated historically with the evolution of Exhibition Place during the early 20th century. The property overlooking Lake Ontario was acquired for the exhibition grounds in 1878 after the provincial agricultural fair (later known as the Canadian National Exhibition or CNE) was permanently established in Toronto. With the gradual expansion of the site eastward to Strachan Avenue and the loss of numerous structures to fire, the grounds were reorganized and new edifices introduced during successive decades. The 1920s marked the unveiling of a ceremonial entrance on Strachan Avenue where the Princes' Gates (1927) opened onto a wide plaza flanked by the Electrical and Engineering Building (1928 and later demolished) on the north and the Automotive Building (1929) to the south. These buildings anchored the east end of the exhibition grounds and showcased the innovative technologies of the period.

The Automotive Building purportedly opened as the largest structure in North America designed exclusively to display passenger vehicles. While the development of the automobile was chronicled in exhibits at the CNE, by the early 1920s its popularity resulted in the opening of a separate structure for automotive products. During the later 20th century, the Automotive Building was upgraded and its purpose expanded from vehicular exhibits to other uses (including a recruitment centre for the Canadian Navy during World War II).

Toronto architect Douglas Kertland won the architectural competition to design the Automotive Building. Kertland received his architectural training in England and worked in the office of the important Canadian architect John M. Lyle before opening a solo practice in Toronto in the 1920s. While he received numerous commissions for churches, hospitals and bank branches, Kertland specialized in residential designs for clients in Forest Hill and other upscale Toronto

neighbourhoods. Kertland received an “honourable mention” in the 1931 Toronto Chapter of the Exhibition of Architecture and Applied Arts for the exterior detailing of the Automotive Building, which remains his best-known project in the city.

Contextually, the Automotive Building is a highly visible feature at Exhibition Place where it is placed inside the Princes’ Gates. Its scale and orientation on the site allow it to be viewed from inside the exhibition grounds and from the parkland along Lake Ontario, which it was designed to overlook across landscaped open space. With its location on the west side of Strachan Avenue where it terminates the vista looking west along Lake Shore Boulevard West, the Automotive Building is a local landmark.

Heritage Attributes

The heritage attributes of the Automotive Building related to its design, associative and contextual value as an excellent example of Modern Classical design with Art Deco detailing that is associated with the evolution of Exhibition Place where it is a local landmark are:

Exterior attributes

- The scale, form and massing.
- The large rectangular plan rising two stories with bevelled corners.
- Above the base of Queenston limestone, the artificial stone cladding with stone and metal detailing.
- The cornice marking the roofline.
- On the principal (south) and north facades, the organization of the walls with central and end pavilions elaborated with frontispieces, piers, cornice mouldings and Classical detailing.
- On the latter elevations, placement of the main entrances in the centre where trios of two-storey round-arched door openings have Classical detailing.
- The treatment of the principal (south) entrance, which is elevated and reached by a stone staircase.
- Flanking the north and south entries, the oversized piers with narrow rectangular window openings and reliefs with Art Deco detailing.
- Above the south and north entrances, the name bands labelled “AUTOMOTIVE BUILDING” in Roman letters.
- On the end pavilions, the trios of round-arched window openings beneath blind balconies with decorative metal screens.

- The bevelled corners, where secondary entrances are placed inside monumental round-arched openings with stone carvings.
- On all the elevations, the organization by stone piers of the two-storey flat-headed window openings with decorative metal spandrels.
- Flanking the south end of the Automotive Building, the landscaped open space.

Interior attributes

- The continuation of the Classical and Art Deco detailing from the exterior to the interior foyers and lobbies described below.
- In the south and north foyers (found inside the south and north entrances), the terrazzo floors, the wall surfaces with niches on the east and west sides, the flat-headed openings with Classical detailing leading into the lobbies, and the Art Deco ceiling fixtures.
- In the south and north entrance lobbies (between the foyers and the auditorium), the coffered ceilings, the Classical detailing on the walls with columns, friezes and cornices, the terrazzo floors, the flat-headed openings with Classical detailing separating the lobbies from the auditorium, the staircases with balustrades and railings, the Art Deco ceiling fixtures and, at the mezzanine level overlooking the foyers, the balconies with decorative metalwork.

SCHEDULE "B"

Part of PIN 21383-0038 (LT)

Part of Water Lot Fronting the Ordnance Reserve designated as PART 1 on Plan 66R-23720

City of Toronto and Province of Ontario
Land Titles Division of the Toronto Registry Office (No. 66)

The hereinbefore described land being delineated by heavy outline on Sketch No. PS-2009-038 dated March 25, 2009, as set out in Schedule "C".

SCHEDULE "C"

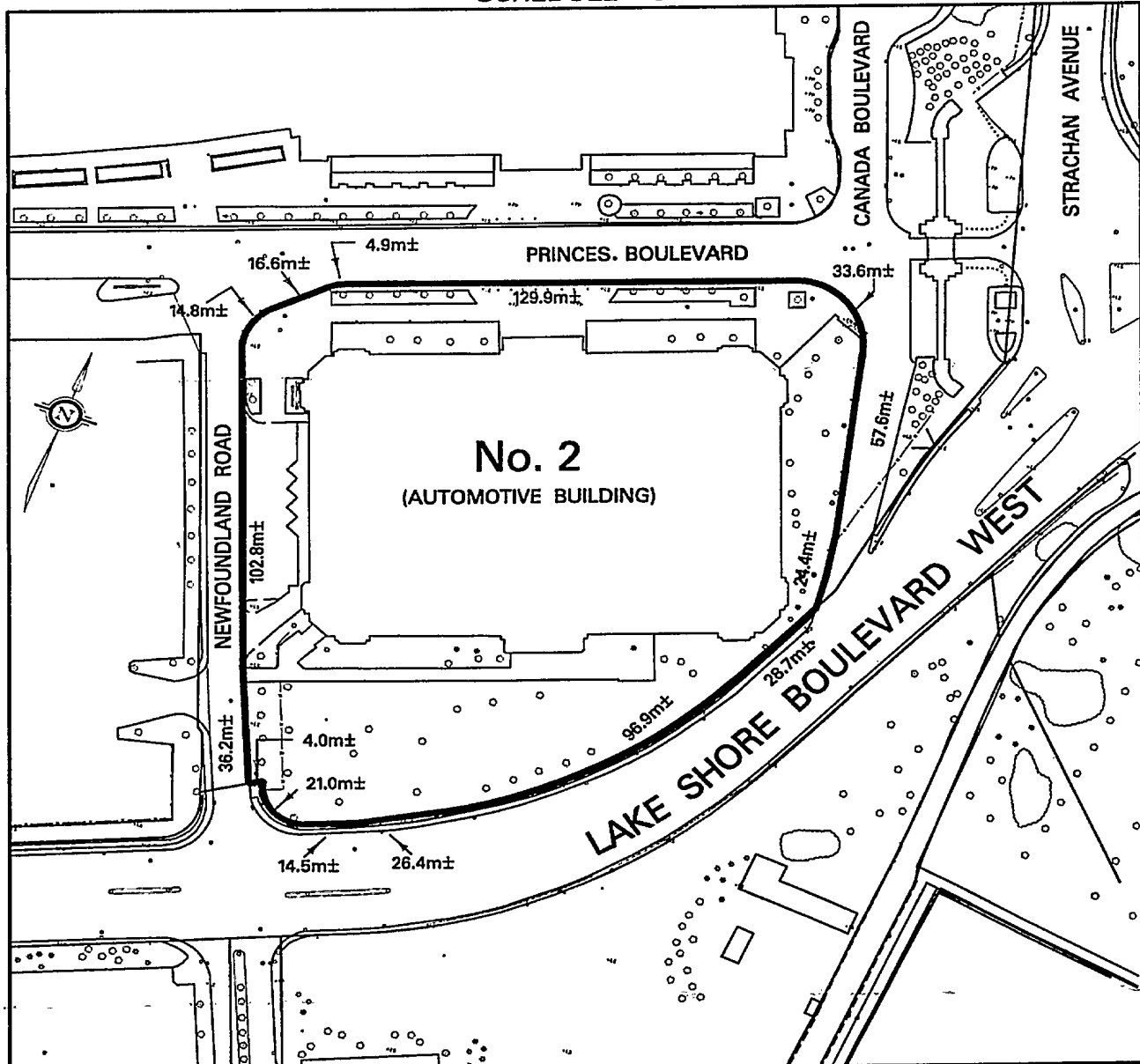

Toronto
TECHNICAL SERVICES DIVISION
SURVEY & MAPPING SERVICES

NOTE:
THIS SKETCH IS NOT
A PLAN OF SURVEY
AND HAS BEEN COMPILED
FROM SURVEY NOTES AND
OFFICE RECORDS. IT SHALL
NOT BE USED EXCEPT FOR
THE PURPOSE INDICATED
IN THE TITLE BLOCK

CHECKED BY: JOHN HOUSE
PREPARED BY: DWAYNE PITT

PROPERTY INFORMATION SHEET

PROPERTY INFORMATION SHEET. NO. 2 STRACHAN
AVENUE (AUTOMOTIVE BUILDING)
LAND DESIGNATED AS BEING OF
CULTURAL HERITAGE VALUE AND INTEREST

(NOT TO SCALE)

WARD 28 - TORONTO CENTRE-ROSEDALE
DATE: MARCH 25, 2009

SKETCH No. PS-2009-038