



An agency of the Government of Ontario



Un organisme du gouvernement de l'Ontario

This document was retrieved from the Ontario Heritage Act Register, which is accessible through the website of the Ontario Heritage Trust at **[www.heritagetrust.on.ca](http://www.heritagetrust.on.ca)**.

---

Ce document est tiré du registre aux fins de la *Loi sur le patrimoine de l'Ontario*, accessible à partir du site Web de la Fiducie du patrimoine ontarien sur **[www.heritagetrust.on.ca](http://www.heritagetrust.on.ca)**.

Properties

PIN	03168 - 0527    LT
Description	PART LOT 8, PLAN 647 RICHMOND HILL AND PART LOT 9, PLAN 647, DESIGNATED AS PART 1, 65R38832; EXCEPT PART 1 65R38747; CITY OF RICHMOND HILL
Address	35 WRIGHT STREET RICHMOND HILL

RECEIVED  
2025/04/10  
(YYYY/MM/DD)  
Ontario Heritage Trust

Applicant(s)

This Order/By-law affects the selected PINs.

Name	THE CORPORATION OF THE CITY OF RICHMOND HILL
Address for Service	225 East Beaver Creek Road Richmond Hill, ON L4B 3P4

This document is being authorized by a municipal corporation David West, Mayor and Stephen M.A. Huycke, City Clerk.  
This document is not authorized   under Power of Attorney by this party.

Statements

This application is based on the Municipality By-law See Schedules.

Signed By

Angela Helen Chamberland	225 East Beaver Creek Road Richmond Hill L4B 3P4	acting for Applicant(s)	Signed	2025 04 09
--------------------------	--	----------------------------	--------	------------

Tel            905-771-8800  
Email        angie.chamberland@richmondhill.ca

I have the authority to sign and register the document on behalf of the Applicant(s).

Submitted By

THE CORPORATION OF THE CITY OF RICHMOND HILL	225 East Beaver Creek Road Richmond Hill L4B 3P4	2025 04 09
--	--	------------

Tel            905-771-8800  
Email        angie.chamberland@richmondhill.ca

Fees/Taxes/Payment

Statutory Registration Fee	\$70.90
Total Paid	\$70.90

File Number

Applicant Client File Number :                      BYLAW 6-25

# **The Corporation of the City of Richmond Hill**

## **By-Law 6-25**

A By-Law to Designate 35 Wright Street (*Enfield: The Edith (Littlefield) and Harry Endean House*) Under the *Ontario Heritage Act*

Whereas Section 29 of the *Ontario Heritage Act*, R.S.O. 1990, c.O.18 authorizes the Council of a municipality to enact by-laws to designate property to be of cultural heritage value or interest;

And Whereas the Council of The Corporation of the City of Richmond Hill ("City Council") has consulted with Heritage Richmond Hill concerning this matter;

And Whereas City Council thereafter caused the City Clerk to serve on the owner(s) of the property known as 35 Wright Street, Richmond Hill, as well as upon the Ontario Heritage Trust, a Notice of Intention to Designate the aforesaid property and has also caused the City Clerk to publish the Notice of Intention to Designate on the City's website in accordance with subsection 26(4) of the *Ontario Heritage Act* and City By-law 12-20, as amended;

And Whereas no Notice of Objection was served upon the City Clerk under subsection 29(5) of the *Ontario Heritage Act*;

And Whereas the Statement of Cultural Heritage Value or Interest, the Description of Heritage Attributes, and a scaled drawing identifying the location of the property's cultural heritage value or interest are set out in Schedule "A" to this by-law;

### **Now Therefore The Council Of The Corporation Of The City Of Richmond Hill Enacts As Follows:**

1. That the property located at 35 Wright Street, being Part of Lots 8 and 9, Plan 647, designated as Part 1, Plan 65R-38832; except Part 1, Plan 65R-38747; Richmond Hill; Regional Municipality of York [PIN 03168-0527 (LT)], is hereby designated under Part IV of the *Ontario Heritage Act*, R.S.O. 1990, c.O.18, as being of cultural heritage value or interest.
2. That the City Clerk is hereby authorized to cause a copy of this by-law to be served on the owner(s) of the property and on the Ontario Heritage Trust, and publish a Notice of the Passing of this by-law on the City's website in accordance with subsection 26(4) of the *Ontario Heritage Act* and City By-law 12-20, as amended.
3. That the City Solicitor is hereby authorized to cause a copy of this by-law to be registered against the property described in Schedule "A" in the Land Registry Office.

The Corporation of the City of Richmond Hill  
By-law 6-25

Page 2

4. That Schedule "A" attached to By-law 6-25 is declared to form a part of this by-law.

Passed this 26<sup>th</sup> day of February, 2025.

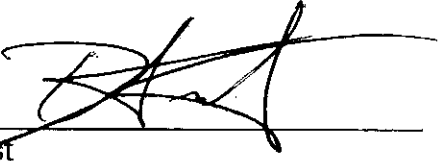
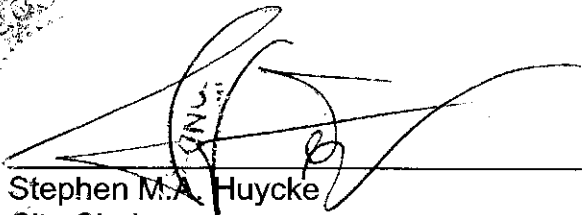
  
\_\_\_\_\_  
David West  
Mayor  
\_\_\_\_\_  
Stephen M.A. Huycke  
City Clerk

File D12-07414

SCHEDULE “A” TO BY-LAW 6-25

REASONS FOR DESIGNATION

35 Wright Street  
Enfield: The Edith (Littlefield) and Harry Endean House

Description of Property

The Edith (Littlefield) and Harry Endean House at 35 Wright Street is a 1 ½-storey brick veneer dwelling located on the north side of Wright Street, west of Yonge Street, and within the historical village of Richmond Hill.

Area of Cultural Heritage Value or Interest

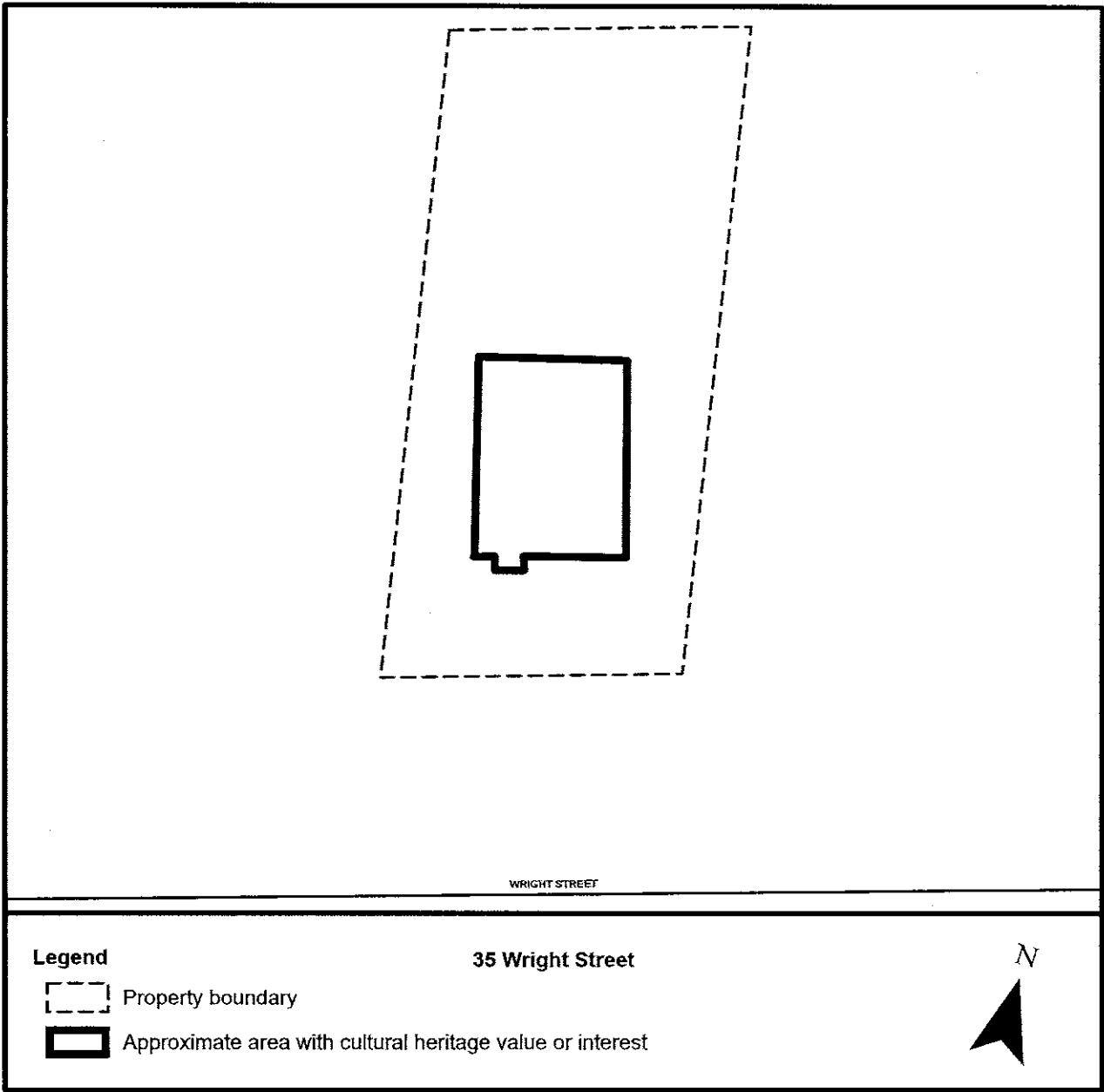

Statement of Significance

Design and Physical Value

Dating to 1921, the Edith (Littlefield) and Harry Endean House at 35 Wright Street has physical value as a representative example of Craftsman residential architecture in Richmond Hill. Architectural features that contribute to the Craftsman style include the

house's rectangular plan and 1 ½-storey massing, the low-pitched side-gabled roof with a large, central-gabled dormer, the brick and shingle cladding, exposed rafter tails, the full-width front porch supported by grouped square columns on brick pedestals, the six-over-one windows organized as singles, pairs, and triples, and the glazed doors.

### Historical and Associative Value

The Edith (Littlefield) and Harry Endean House at 35 Wright Street has historical value for its direct associations with Edith (Littlefield) and Harry Endean. The couple built the house in 1921, named it "Enfield" in reference to their two last names, resided there until around 1933, and owned the property until 1941. Both Edith and Harry Endean were active members of the Richmond Hill community in the early and mid-20<sup>th</sup> century and contributed to the village's economic and social development during this time through their family business, the Endean Nurseries, along with their volunteer efforts for many different organizations and causes.

The Edith (Littlefield) and Harry Endean House at 35 Wright Street has further historical value because it yields information about the Endean Nurseries business and the successful horticultural and floral industry that developed in Richmond Hill in the early 20<sup>th</sup> century. Richmond Hill's flower industry helped shape the village's economy and identity in the first half of the 20<sup>th</sup> century. The village incorporated the rose into its crest and motto in the early 20<sup>th</sup> century and had proclaimed itself the Rose Capital of Canada by the late 1920s.

### **Heritage Attributes**

#### Design and Physical Value

Heritage attributes contributing to the value of the property as a representative example of residential Craftsman architecture in Richmond Hill are:

- The scale, form and massing of the 1 ½-storey building with a rectangular plan;
- The low-pitched side-gable roof with a large central dormer on its principal (south) slope, and exposed rafter tails at dormer and porch eaves;
- The exterior materials, comprised of a concrete foundation, orange brick cladding, and wood shingles at the second storey;
- The balanced, two-bay composition of the south (front) elevation;
- The windows, including:
  - Segmental-arched ground-floor and basement windows with brick voussoirs and rusticated concrete sills on the building's west, south, and east elevations;
  - Flat-headed second-storey windows with wood surrounds and concrete sills;
  - Period wood window units, most in a six-over-one configuration, where extant;
- The doors, including:
  - Segmental-arched ground-floor doors on the principal (south) and west elevations with brick voussoirs;
  - Period wooden door units with glazing, where extant.
- The full-width front porch, including:
  - The shed roof with exposed rafter tails at the eaves;
  - The grouped square columns with square capitals on orange brick pedestals with stone caps;
  - The cornice with peaked arches;

- The wooden railings with square balusters and newel posts; and
- The central brick chimney located at the peak of the roof.

Historical and Associative Value

Heritage attributes that contribute to the value of the property for its associations with significant Richmond Hill business owners and community members Edith (Littlefield) and Harry Endean are:

- The property's scale, siting and orientation on the north side of Wright Street, west of Yonge Street; and
- The house's Craftsman 1920s architectural style and material palette.

Note: the house's one-storey frame rear (north) addition is not considered to possess heritage attributes.