



An agency of the Government of Ontario



Un organisme du gouvernement de l'Ontario

This document was retrieved from the Ontario Heritage Act e-Register, which is accessible through the website of the Ontario Heritage Trust at **www.heritagetrust.on.ca**.

Ce document est tiré du registre électronique, tenu aux fins de la *Loi sur le patrimoine de l'Ontario*, accessible à partir du site Web de la Fiducie du patrimoine ontarien sur **www.heritagetrust.on.ca**.



**THE CORPORATION OF THE TOWN OF GODERICH
BY-LAW NO. 97 OF 2009**

A by-law to designate property of cultural heritage value or interest under the terms of Section 29 of the Ontario Heritage Act, R.S.O. 1990, Chapter 0.18, as amended.

WHEREAS the Ontario Heritage Act, R.S.O. 1990, Chapter 0.18, as amended, authorizes Council of a municipality to enact by-laws to designate real property, including all the buildings and structures thereon to be of cultural heritage value or interest;

AND WHEREAS the Council of the Corporation of the Town of Goderich has cause to be served upon the owner of the land and premises of the Lighthouse, 280 Cobourg Street, Goderich and upon the Ontario Heritage Trust Notice of Intention to Designate this real property and has caused such Notice of Intention to be published in a newspaper having a general circulation in the municipality;

AND WHEREAS no Notice of Objection to the said proposed designation has been served upon the Clerk of the municipality.

NOW, THEREFORE, THE COUNCIL OF THE CORPORATION OF THE TOWN OF GODERICH ENACTS AS FOLLOWS:

1. All real property, described as the Lighthouse, 280 Cobourg Street, Goderich, Ontario is designated as being of cultural heritage value or interest.
2. The Town Solicitor is hereby authorized to cause a copy of this by-law to be registered against the property described as Part of Lot A, Registered Plan 469, Town of Goderich, County of Huron, designated as Parts 14 and 15 on Plan 22R4452, 280 Cobourg Street, Goderich, Ontario, in the land registry office.
3. The Town Clerk is hereby authorized to cause a copy of this by-law to be served on the owner of the property described as the Lighthouse, 280 Cobourg Street, Goderich, Ontario and upon the Ontario Heritage Trust and to cause notice of this by-law to be published in a newspaper having a general circulation in the Town of Goderich.

READ A FIRST, SECOND AND THIRD TIME AND FINALLY PASSED THIS THIRTEENTH DAY OF OCTOBER, 2009.

MAYOR

CLERK

Designation of the Goderich Lighthouse considered to be of cultural heritage value and/or interest under the provisions of Section 29 of the *Ontario Heritage Act*, R.S.O 1990, as amended.

Schedule 'A'

Identification

| | | | |
|----------------------------|---------------------|--------------|---------------------------------|
| Historic Place Name | Goderich Lighthouse | | |
| Other Names | # | Type: | Name: |
| | 1 | Other | 280 Cobourg Street, Goderich ON |

Recognition

| | |
|--------------------------|--|
| Authority: | Local Government (ON) |
| Recognition Type: | Municipal Heritage Designation Part IV |
| Recognition Date: | 2009-10-13 |

Location

Location

| | |
|-------------------------|--|
| Building Number: | 280 |
| Street Name: | Cobourg Street |
| Postal Code: | n/a |
| Locality: | Residential area in the Town of Goderich |
| Community: | Town of Goderich |
| Upper Tier: | County of Huron |

Coordinates

| | | | |
|-----------------------|--|-----------------------|------------------|
| UTM: 441646, 4843489 | | Latitude/Longitude | |
| Determination: | | Determination: | Geocoding |
| Datum: | | Datum: | NAD83 |
| Zone: | | Latitude: | 43 44 31.7 (DMS) |
| Northing: | | Longitude: | 81 43 28.9 (DMS) |
| Easting: | | | |
| Borden #: | | Borden #: | |

Designation of the Goderich Lighthouse considered to be of cultural heritage value and/or interest under the provisions of Section 29 of the *Ontario Heritage Act*, R.S.O 1990, as amended.

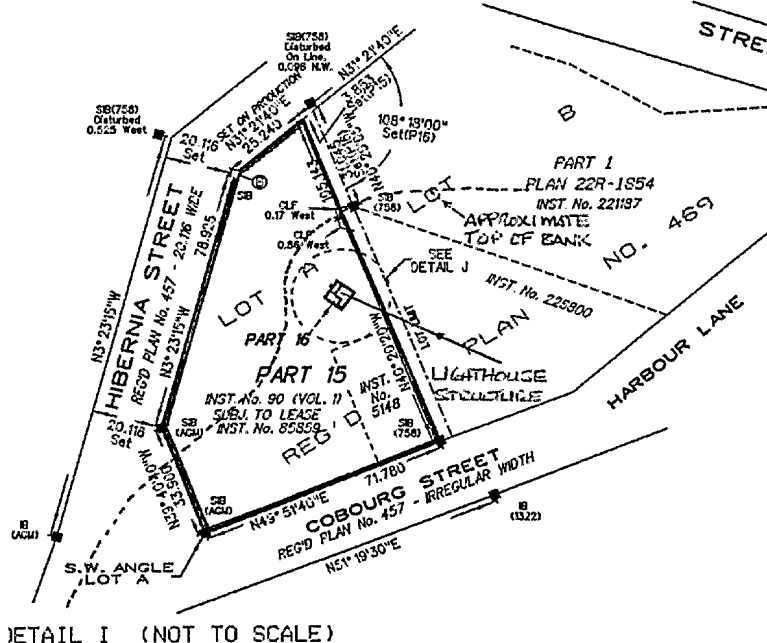
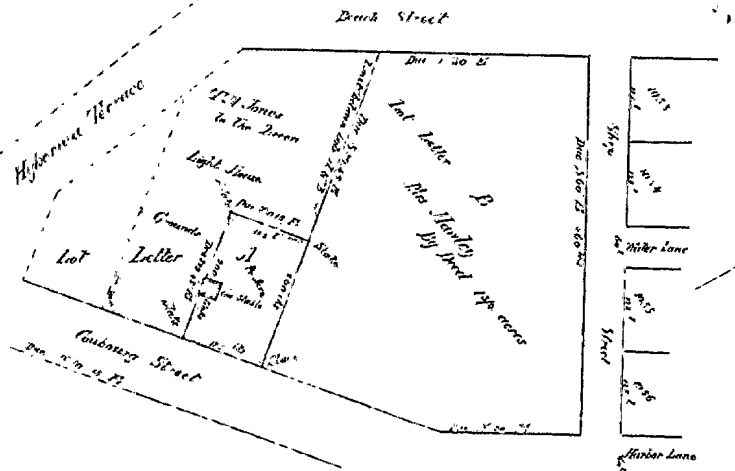
| | |
|-------------------------------------|--|
| <p>Boundary Description:</p> | <p>Boundaries PLAN 469 PT LOT A; AS RP 22R4452 PARTS 14, 15. The parcel of land is bordered by Cobourg Street, a public thoroughfare, and Hibernia (Terrace) Street. You can still walk on part of the terraced area about halfway down the hill if you follow the steps by foot.</p> <p><i>Reference: Figure 1 Current Survey and Figure 2. Early 1800's Survey of Lands</i></p>  <p>DETAIL I (NOT TO SCALE)</p> |
| | <p>Figure 2</p>  <p><i>original sent to be registered in the County of Huron.</i></p> <p>Figure 2</p> |

Designation of the Goderich Lighthouse considered to be of cultural heritage value and/or interest under the provisions of Section 29 of the *Ontario Heritage Act*, R.S.O 1990, as amended.

Aerial Mapping 2006 – Prepared with Huron County Geographic Information System (GIS) Mapping

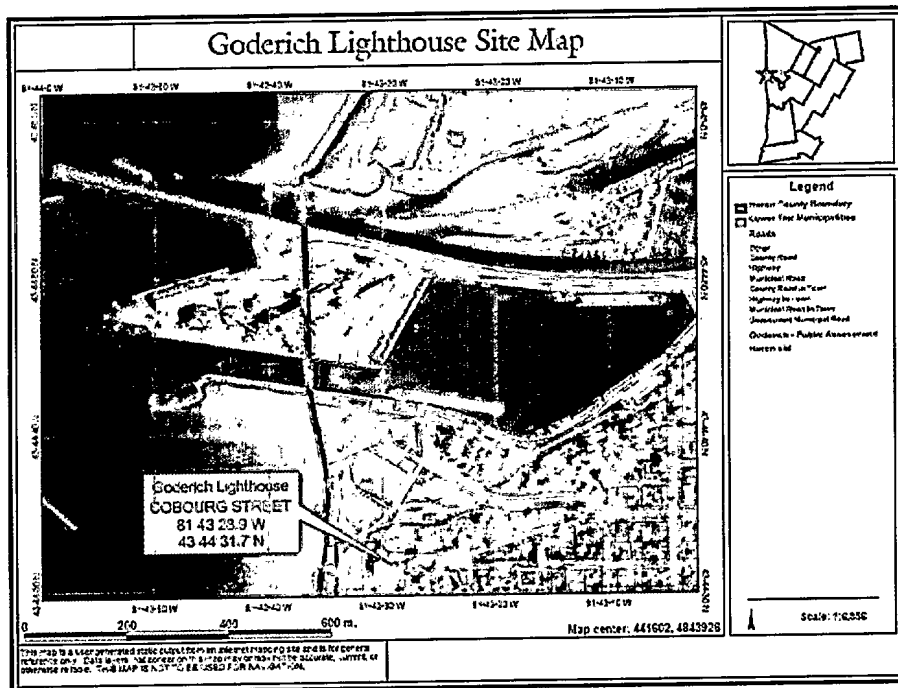

Harbour Mapping 1880 (Red circle - lighthouse site) – Acquired from Library & Archives Canada

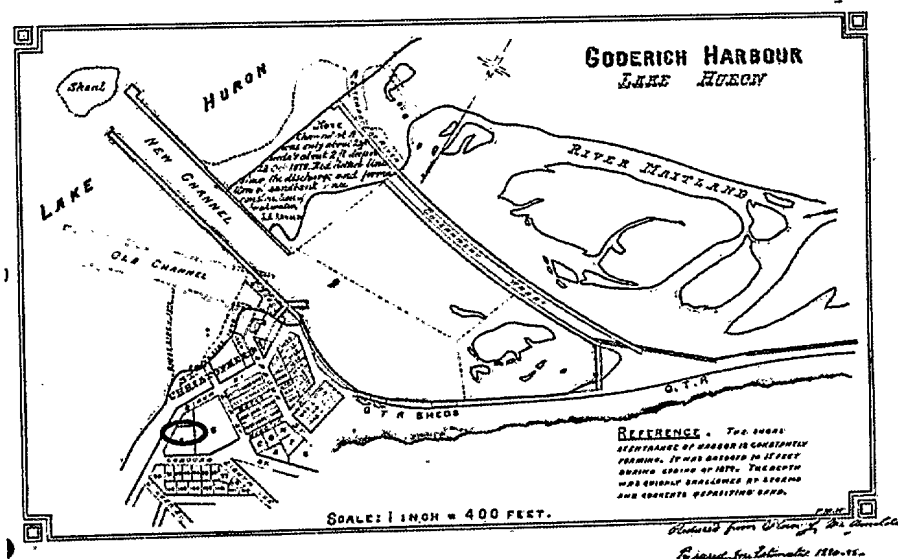

Designation of the Goderich Lighthouse considered to be of cultural heritage value and/or interest under the provisions of Section 29 of the *Ontario Heritage Act*, R.S.O 1990, as amended.

Description

Statement of Significance

| | |
|---|--|
| <p>Description of Historic Place: i.e. Description of Property</p> | <p>The Goderich Lighthouse is an aid to navigation on Lake Huron, located on a cul-de-sac at the south end of Cobourg Street in a well-maintained and treed residential section of Goderich. Surrounded by open space, the Lighthouse sits on a prominent geographical point 45 metres above water level overlooking the Goderich waterfront and Lake Huron. From a point on Cove Road, a public thoroughfare running parallel to the shoreline along the toe of the bank below the lighthouse, stairs ascend to the top of the bluff exiting at the access door to the lighthouse, which faces west.</p> <p>At a height of 10.1 metres (<i>approx. 33 feet</i>), it is almost square in shape, differing from the usual lighthouse construction of that era. The tower was built of evenly-coursed stone. Ontario Heritage Act, Part IV designation bylaw # 97 of 2009</p> |
| <p>Heritage Value: i.e. Statement of Cultural Heritage Value or Interest</p> | <p>Historical or Associative Value: As a result of an inherent natural harbour, and the astute planning of founders, Tiger Dunlop and John Galt, the Port of Goderich was established in 1827. From the beginning, life in Goderich evolved around the activity at the harbour front. Almost two centuries later, it continues to play an integral part in the vitality of the community.</p> <p>Erected in 1847, the Goderich Lighthouse is recognized as the first lighthouse on the Canadian Shore of Lake Huron. Construction of the lighthouse was overseen by the Department of Public Works and built for the purpose of protecting and guiding mariners travelling near the mouth of the Maitland River, prone to strong nor' westerly gales. Of note, the general increase of traffic on the Great Lakes, which followed the opening of the Sault Ste. Marie canal in 1855, precipitated the construction of more lights.</p> <p>Contextual Value: Construction of the Goderich lighthouse directly aided the development of the town as a significant centre for maritime and port-related industries on Lake Huron.</p> <p>From a socio-economic standpoint, the harbour provides a significant employment base in the community with representation from the mining, storage, commercial fishing, recreational, and transportation sectors.</p> <p>The salt mine, the largest working mine of its kind, loads over 6 million tons of salt into vessels, who arrive from all parts of the Great Lakes. Furthermore, the storage capacity at Goderich Elevators is 120,000 metric tons, and the annual tonnage handled in and out is at least 300,000 tons—a major link in the grain industry chain for producers and consumers alike. The massive ocean freighters, or 'Salties', which carry their cargo through the St. Lawrence Seaway out to sea, transport white beans and grain to locations as far away as Japan.</p> <p>The Goderich Lighthouse, considered one of the most powerful lights on the Great Lakes, continues to be a welcoming and essential 'Aid to Navigation' to the hundreds of boats entering its harbour annually. A harbour of refuge, the Port of Goderich is the busiest and deepest seaport along the Canadian shore of Lake Huron. In addition, the lighthouse contributes to the area's tourism by attracting lighthouse and maritime enthusiasts to its port.</p> |

Designation of the Goderich Lighthouse considered to be of cultural heritage value and/or interest under the provisions of Section 29 of the *Ontario Heritage Act*, R.S.O 1990, as amended.

| | |
|--|--|
| | <p>Site If a view of Goderich harbour noted in photographs from 1896 (<i>Figure 1</i>) is accurate, the Goderich light station seems at one time to have had a number of outbuildings. A dwelling attached to the tower, possibly erected with the tower in 1847, was repaired in 1876, added to in 1880 and removed about 1914, leaving the tower standing alone on the site for more than 75 years. In 1941 - 42, a park was created around the tower.</p> <p>Designer The Goderich light tower was designed by the Department of Public works and built at a cost of 492.7.0 (pounds).</p> <p>Craftsmanship and Materials Adam MacVicar, the stonemason for the lighthouse, handled the work for the Goderich tower in a very neat and competent manner. The short (6.1m – Base to Vane) almost square Goderich light tower was an uncommon design for Public Works (<i>and for its successor, the Department of Marine and Fisheries</i>) unlike almost all masonry towers built before and after, it was not tall, round or tapered. Although, there was no need for a tower of great height at this site, as the location chosen was about 45 meters above the water on a natural eminence. The answer to why the design of the tower was almost square and straight-sided is unknown (<i>although, cylindrical lighthouses aside, this was a conventional shape for stone structures.</i>)</p> <p>The tower was built of evenly coursed stone, with a string course below the gallery and another between the first and second storey. Small narrow windows, two to each floor, are located on the seaward and landward façades. The window back moulds have been described as a flattened Greek ovolo, typical of the 1840's.</p> <p>In 1914, the tower was heightened, and the gallery railing and stone lantern deck were replaced. This new deck was similar to the original, but had a slightly wider projection and introduced a cavetto (large cove moulding) to the cornice (around the top of the stonewall.)</p> <p>Windows & Interior There are four small wood framed double hung windows in the stone tower. Two on the south side and two on the north side that shed natural sun light into the stone tower's interior.</p> <p>The Lighthouse's two-storey interior contains a staircase from the main floor up to the second floor and a steep staircase from the second floor up to the roof top lantern. The interior stairways can be better described as stairways that are more like ladders or ladders that look like stairways. Image (4) show how steep they are, almost vertical. These "ladder stairways" are easier to go up, than to go down.</p> |
|--|--|

Designation of the Goderich Lighthouse considered to be of cultural heritage value and/or interest under the provisions of Section 29 of the *Ontario Heritage Act*, R.S.O 1990, as amended.

Reference: Transport Canada (CCG) Drawing AR-11185 dated 7/11/13.

LIGHTTOWER, GODERICH, ONTARIO

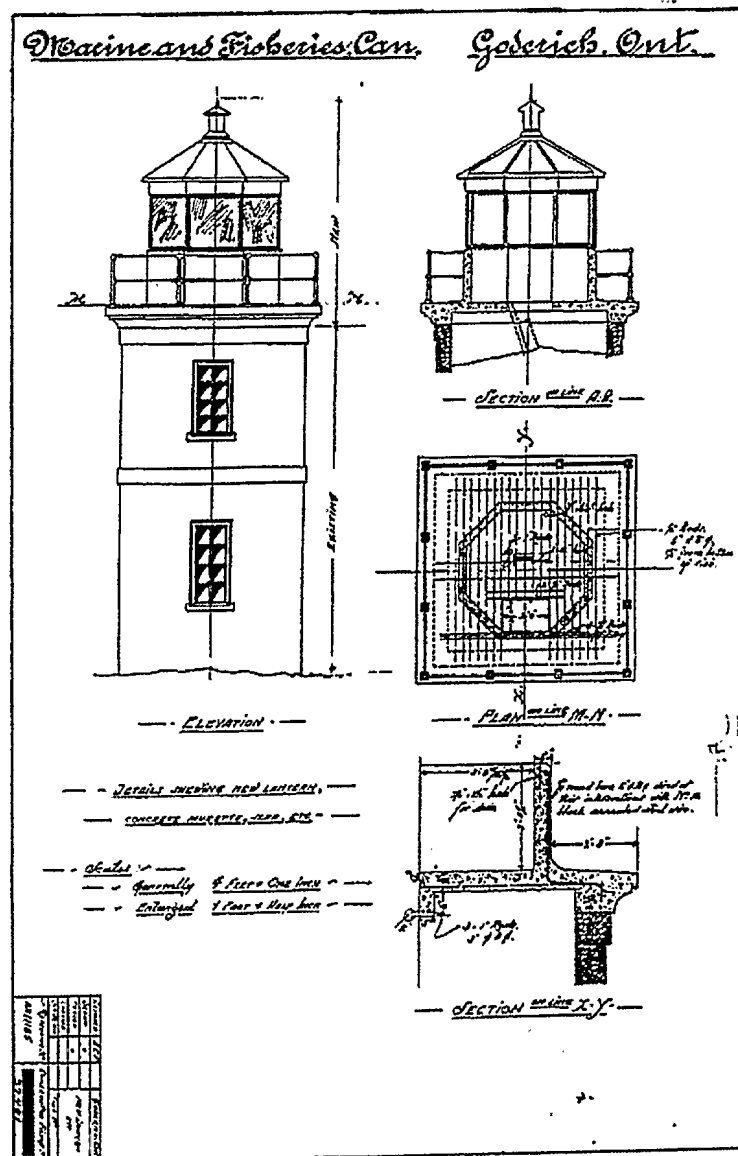

Figure 3. "Goderich, Ont.: Details shewing new lantern, concrete murette, slab, etc." Transport Canada (CCG), Drawing AR-11185, 7/11/13

While the general appearance of the tower proper has changed very little since it has been standing, the removal of its attached dwelling has significantly altered its look.

Designation of the Goderich Lighthouse considered to be of cultural heritage value and/or interest under the provisions of Section 29 of the *Ontario Heritage Act*, R.S.O 1990, as amended.

| | | | |
|--|--|--------------------------------------|-------------------------|
| Character-Defining Elements: i.e. Description of Heritage Attributes | <i>Information received from the Canadian Coast Guard in 2001 revealed the following:</i> | | |
| | <i>Lighthouse</i> | <i>10.1 meters high</i> | <i>(about 33 feet)</i> |
| | <i>Light above water</i> | <i>42.7 meters above chart datum</i> | <i>(about 140 feet)</i> |
| | <i>Light from water's edge</i> | <i>140 meters</i> | <i>(about 460 feet)</i> |
| | <i>Elements that contribute to the historical or associative value of the Goderich Lighthouse include:</i> | | |
| | <ul style="list-style-type: none">• built of evenly-coursed stone, with a string course below the gallery and another between the first and second storey• tower was built almost square and straight-sided• small, narrow windows, one to each floor, are located on the seaward and landward façades.• window back moulds described as a flattened Greek ovolo, typical of the 1840's• an 8-sided iron-framed lantern, concrete murette, and slab crown the top of the tower | | |

| | | | |
|-------------------------------|---|---------------------------------|----------------------------------|
| Contributing Resources | | Type: | Count: |
| | | Building | 1 |
| | | Landscape(s) or Landscape Feat. | Public park surrounds lighthouse |
| | | Structure | |
| Area (m²) | | | |
| Dates of Significance | # | Type: | From: To: |
| | 1 | Construction (Lighthouse) | 1847 1847 |
| | 2 | Construction (Circa) | |
| | 3 | Significant | |
| BA | # | Type: | Name: |
| | 1 | Architect | Department of Public Works |
| | 2 | Builder | Charmin Construction Company |

Function Category and Type

Images

| | Image 1: | Image 2: | Image 3: | Image 4: |
|---------------------|--|---|---|--|
| File Path: | | | | |
| Image Type: | Reproduction | Reproduction | Contemporary Photograph | Contemporary Photograph |
| Caption: | Goderich Lighthouse & Keeper's Dwellings 1896 | Goderich Lighthouse & attached Weather Porch 1914 (View from west) | Goderich Lighthouse 2007 (View from west) | Goderich Lighthouse Interior 2007 |
| Description: | Of note are the small narrow windows, two (2) to each floor providing natural light into the interior of the tower. The windows are located on the seaward and landward façades. | Of note is a small Italianate Styled Weather Porch, which protected the west entrance door to the Lighthouse. Photo shows finished alterations after Storm of 1913 inquest. | Of note is the cavetto (large cove moulding) to the cornice (around the top of the stone wall). | Lighthouse's two storey interior contains a staircase from the main floor up to the second floor and a staircase from the second floor up to the roof top lantern. |
| Copyright: | Library & Archives Canada | Library & Archives Canada | John Rutledge | John Rutledge |

Designation of the Goderich Lighthouse considered to be of cultural heritage value and/or interest under the provisions of Section 29 of the *Ontario Heritage Act*, R.S.O 1990, as amended.

Image 1

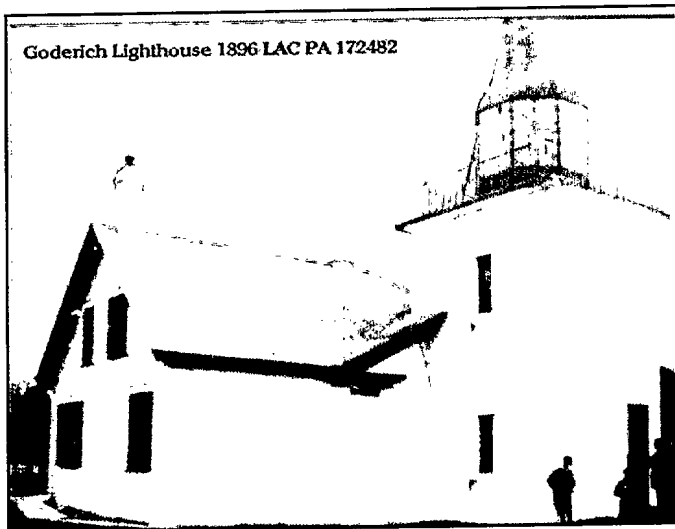

Image 2

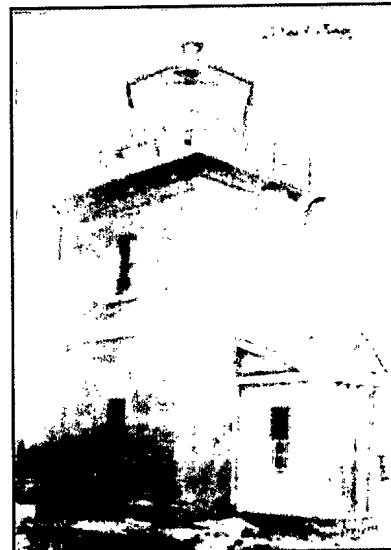

Image 3



Image 4



Designation of the Goderich Lighthouse considered to be of cultural heritage value and/or interest under the provisions of Section 29 of the *Ontario Heritage Act*, R.S.O 1990, as amended.

Resources

| | | | |
|-------------------------------|---|--------------------------|--------------------------|
| Location of Documents: | (a) Town of Goderich, Town Hall 57 West Street ON N7A 2K5 (b) Architectural Conservancy of Ontario (Preservation Works) – The Lighthouse, the “I” in Goderich prepared by John Rutledge November 2007, 39A West Street, Goderich ON N7A 2K5 (c) Architectural History Branch of the Federal Heritage Building Review Office Building Report 90-195 Prepared: Year 1991, Ottawa ON (d) Transport Canada (CCG) Drawing AR-11185 Date November 7, 1913, Ottawa ON | | |
| Collections: | | | |
| Related Link | URL: | Type: | Description: |
| | http://www.goderich.ca/marine/marinehome.htm http://www.goderich.ca/heritage | Local Government Website | Town of Goderich Website |

Management

| | |
|------------------------|----------------|
| Ownership Type: | Public (Local) |
|------------------------|----------------|



NOTICE OF PASSING OF BY-LAW

The Council of the Corporation of the Town of Goderich passed By-law No. 97 of 2009 on the 13th day of October, 2009, being a by-law to designate property of cultural heritage value or interest, the Lighthouse, 280 Cobourg Street, Goderich

Larry J. McCabe
Clerk-Administrator
Town of Goderich
57 West Street
Goderich, ON N7A 2K5
lmccabe@goderich.ca

391721