



An agency of the Government of Ontario



Un organisme du gouvernement de l'Ontario

This document was retrieved from the Ontario Heritage Act e-Register, which is accessible through the website of the Ontario Heritage Trust at **[www.heritagetrust.on.ca](http://www.heritagetrust.on.ca)**.

---

Ce document est tiré du registre électronique. tenu aux fins de la *Loi sur le patrimoine de l'Ontario*, accessible à partir du site Web de la Fiducie du patrimoine ontarien sur **[www.heritagetrust.on.ca](http://www.heritagetrust.on.ca)**.



# The City of Stoney Creek

RM of Hamilton-Wentworth

January 20, 1995

Ontario Heritage Foundation  
Ministry of Culture & Communications  
2nd Floor - 77 Bay St. W.  
Toronto ON M7A 2R9

**Re: City of Stoney Creek - Notice of Intention to Designate  
- 1317 Highway No. 8**

As per the Ontario Heritage Act, R.S.O., 1990, Chapter 0.18, the City of Stoney Creek wishes to advise that during the period of November 30 to December 14, 1994, a notice was advertised in The Stoney Creek News advising of the Notice of Intention to Designate 1317 Highway No. 8.

No *Notices of Objections* were received by the City, and it is intended to enact the designating by-law at the Council meeting to be held on January 31, 1995.

A copy of the Director or Planning's Report No. PL94-60 adopted at the November 22, 1994 Council meeting is enclosed for your information.

Please provide correspondence pertaining to this matter to the undersigned.

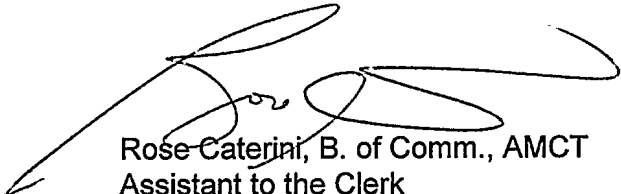
  
Rose Caterini, B. of Comm., AMCT  
Assistant to the Clerk

Attachment

Copy to:

Wm. Denny  
P. Smithson, Planning Department

## **The Corporation of the City of Stoney Creek**

**IN THE MATTER OF THE ONTARIO HERITAGE ACT, R.S.O., 1990, CHAPTER 0.18  
AND IN THE MATTER OF THE LANDS AND PREMISES AT 1317 HIGHWAY NO. 8, CITY OF  
STONE CREEK, PROVINCE OF ONTARIO**

### **NOTICE OF INTENTION TO DESIGNATE**

**Take Notice,** That the Council of the Corporation of the City of Stoney Creek intends to designate the property, including lands and buildings at the following municipal address as a property of architectural and historic value and interest under Part IV of The Ontario Heritage Act. R.S.O., 1990, Chapter 0.18.

This brick structure exhibits a fine example of the Queen Anne Architectural style which was popular in Ontario in the late 1800's.

The Pettit family has been connected with the history of Saltfleet Township at least as early as 1796 when Nathaniel Pettit was granted land in the township. The Pettits were part of the first group of United Empire Loyalists to come to this area having arrived at The Forty, now called Grimsby, from New Jersey circa 1787. On October 12, 1796 several family members petitioned Governor John Graves Simcoe and were granted Loyalist status having proved their loyalty to Britain during the American Revolution.

Charles Pettit, who had married Mary Smith, took up residence in Saltfleet about 1787 and was granted several hundred acres of land in Saltfleet in 1798. He was appointed Commissioner of Roads at a Land Board meeting held on March 31, 1790. He was involved with the building of St. Andrew's Episcopal (Anglican) Church in Grimsby, allowing his home to be used for a communion service in 1803.

His son, John Charles, also settled in Saltfleet about the same time and gave the land upon which St. John's Anglican Church in Winona is built. A plaque to this memory is located in the church.

A number of other family members have resided in Saltfleet including Catherine Gage Pettit, a daughter of Charles and Mary Pettit. A part of her wedding trousseau is found in the collections of the Royal Ontario Museum in Toronto including a Jacquard quilt loomed in the early 1800's with "*Catherine Gage Pettit, 1853*" woven in the corner and another quilt with the embroidered date "*1860-1865*".

The Pettit family is connected with many of the early pioneer families of the former Saltfleet Township. The names of several Pettit family members are also found in the War of 1812 muster records, having served in that conflict.

The original brick one and one-half storey house was built in the Gothic style in 1856. The main part of the present structure consists of the two-storey addition built to the east of the original house in 1898. A further one-storey addition erected to the north side in the 1960's has no particular architectural merit.

The main structure presents a pleasing harmonious exterior with an elaborately detailed two-tiered porch which exhibits wood turned posts and decorative fretwork supporting the spindle frieze.

The large variety of different decorative elements commonly displayed in buildings of this architectural style are demonstrated in this structure. The two different semi-circular arches over the windows on the south facade, the semi-circular window on the east facade and the chimney on the east facade, which is embellished with patterned brickwork, are typical examples.

The south facade is anchored by the projecting, three- sided, two- storey bay typical of the Queen Anne style. The bay is accented by an intricately patterned gable which is supported on each side by delicately cut-out wood brackets.

Important to the preservation of the Pettit House are the exterior brick of the original facade, the windows and the original foundations and chimneys.

Also important to the preservation are the gable and wood brackets, as well as the two-tiered veranda, including the soffit, fascia, posts, wood brackets and spindles.

Inquiries may be directed to Paul Smithson, Planning Department, City of Stoney Creek at 643-1261.

Any person may, within thirty days of the first publication of this notice, send by registered mail or deliver to Joseph A. Brezina, Clerk of the City of Stoney Creek notice of his or her objection to the proposed designation together with a statement of the reasons for the objection and all relevant facts. If such a Notice of Objection is received, the Council of the Corporation of the City of Stoney Creek shall refer the matter to the Conservation Review Board for a hearing.

J. A. Brezina, A. M. C. T.  
City Clerk

## City of Stoney Creek

## Planning Department

Prepared for Planning Committee  
 Agenda Date November 10, 1994

Report No. PL94 - 60  
 Report Date October 3, 1994

**Subject**

Request by [REDACTED] and the City of Stoney Creek L.A.C.A.C. to Designate the Pettit House "Evanleigh", 1317 Highway No. 8, under the Ontario Heritage Act - File No. LD93-7

**Summary of Recommendation**

That the request to designate the Pettit House "Evanleigh" under the Ontario Heritage Act be endorsed by Planning Committee and Council.

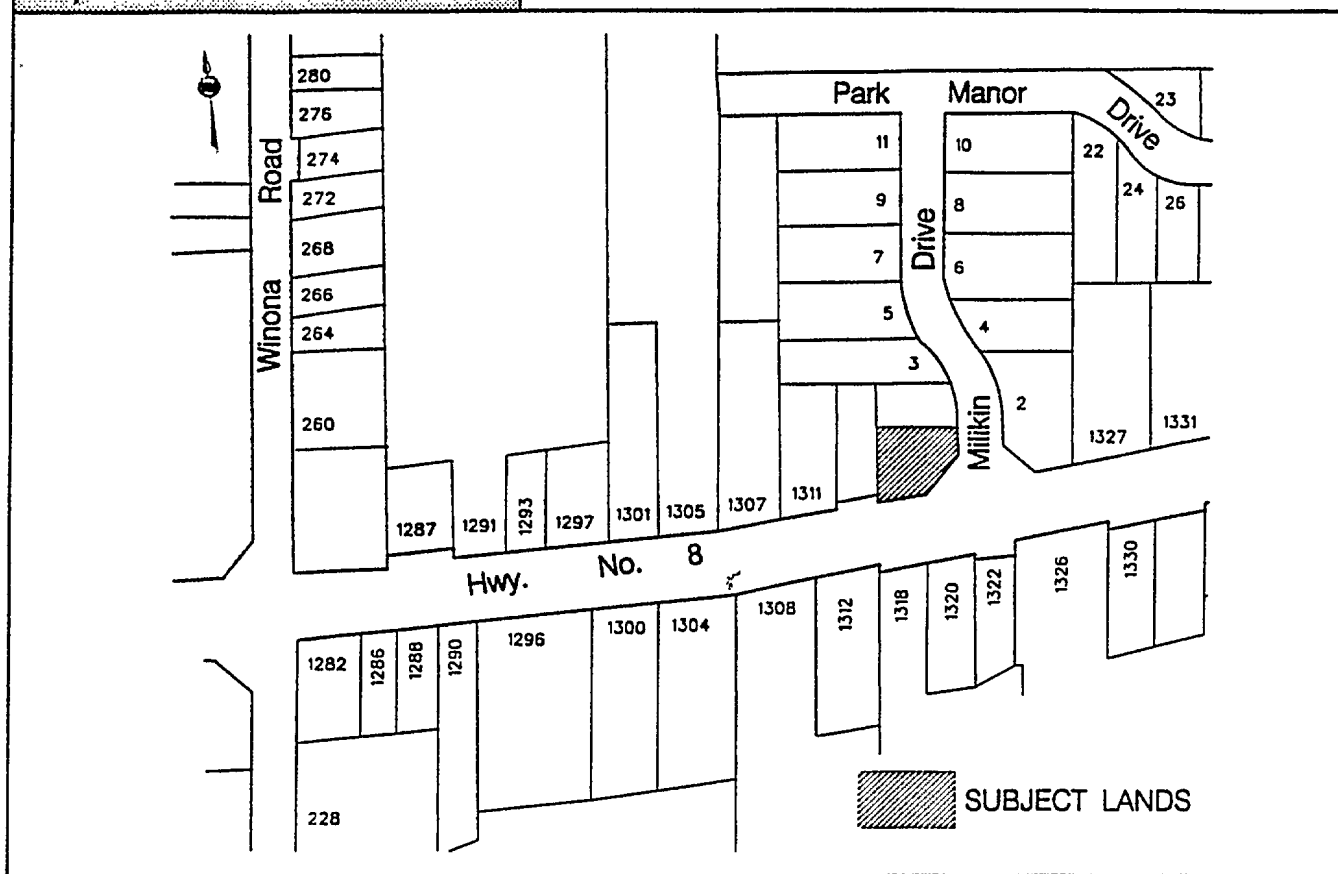
**Map**

Respectfully submitted

*R. M. Marini*

R. M. Marini, M.C.I.P.  
 Director of Planning

Approved by

*Paul Smithson*

Paul Smithson, M.A., M.C.I.P.  
 Manager of Land Use and Policy

## INTRODUCTION

The current owners of the building, [REDACTED], have requested designation under the Ontario Heritage Act for their house located at 1317 Highway No. 8.

The Planning Department has received a recommendation from the Stoney Creek LACAC, resulting from their meeting of September 20, 1994, requesting that the historical and architectural qualities of the Pettit House, located at 1317 Highway No. 8, be designated under the Ontario Heritage Act as the Pettit House is of historical and architectural value. The Stoney Creek LACAC Research Sub-committee has outlined the architectural and historical reasons for designation in this report.

### *Historical Qualities*

The Pettit family has been connected with the history of Saltfleet Township at least as early as 1796 when Nathaniel Pettit was granted land in the township. The Pettits were part of the first group of United Empire Loyalists to come to this area having arrived at The Forty, now called Grimsby, from New Jersey circa 1787. On October 12, 1796 several family members petitioned Governor John Graves Simcoe and were granted Loyalist status having proved their loyalty to Britain during the American Revolution.

Charles Pettit, who had married Mary Smith, took up residence in Saltfleet about 1787 and was granted several hundred acres of land in Saltfleet in 1798. He was appointed Commissioner of Roads at a Land Board meeting held on March 31, 1790. He was involved with the building of St. Andrew's Episcopal (Anglican) Church in Grimsby, allowing his home to be used for a communion service in 1803.

His son, John Charles, also settled in Saltfleet about the same time and gave the land upon which St. John's Anglican Church in Winona is built. A plaque to this memory is located in the church.

A number of other family members have resided in Saltfleet including Catherine Gage Pettit, a daughter of Charles and Mary Pettit. A part of her wedding trousseau is found in the collections of the Royal Ontario Museum in Toronto including a Jacquard quilt loomed in the early 1800's with "*Catherine Gage Pettit, 1853*" woven in the corner and another quilt with the embroidered date "*1860-1865*".

The Pettit family is connected with many of the early pioneer families of the former Saltfleet Township. The names of several Pettit family members are also found in the War of 1812 muster records, having served in that conflict.

### *Architectural Qualities*

This brick structure exhibits a fine example of the Queen Anne Architectural style which was popular in Ontario in the late 1800's.

The original brick one and one-half storey house was built in the Gothic style in 1856. The main part of the present structure consists of the two-storey addition built to the east of the original house in 1898. A further one-storey addition erected to the north side in the 1960's has no particular architectural merit.

The main structure presents a pleasing harmonious exterior with an elaborately detailed two-tiered porch which exhibits wood turned posts and decorative fretwork supporting the spindle frieze.

The large variety of different decorative elements commonly displayed in buildings of this architectural style are demonstrated in this structure. The two different semi-circular arches over the windows on the south facade, the semi-circular window on the east facade and the chimney on the east facade, which is embellished with patterned brickwork, are typical examples.

The south facade is anchored by the projecting, three- sided, two- storey bay typical of the Queen Anne style. The bay is accented by an intricately patterned gable which is supported on each side by delicately cut-out wood brackets.

### ***Designating Features***

Important to the preservation are the exterior brick of the original facade, the windows and the original foundations and chimneys.

Also important to the preservation are the gable and wood brackets, as well as the two-tiered veranda, including the soffit, fascia, posts, wood brackets and spindles.

### **REVIEW OF POLICES AFFECTING PROPOSAL**

n/a

### **COMMENTS FROM RELEVANT DEPARTMENTS**

n/a

### **FINANCIAL/STAFFING/LEGAL IMPLICATIONS**

n/a

### **DISCUSSION**

n/a

### **CONCLUSION**

n/a

### **RECOMMENDATION**

Based on the foregoing, it is recommended that the request of the owners, which is supported by the Stoney Creek Local Architectural Conservation Advisory Committee, to designate the Pettit House "Evanleigh", located at 1317 Highway No. 8, be endorsed by Planning Committee and Council.

It is further recommended that:

1. the process of registration of the draft designating By-law be initiated in accordance with the Ontario Heritage Act;
2. the Clerk be directed to provide notice of Council's intention to designate the Pettit House "Evanleigh" in accordance with the provisions of the Ontario Heritage Act; and
3. upon passing of the By-law and registration of the subject property as a heritage building, in accordance with the provisions of the Ontario Heritage Act, that Planning staff be authorized to order a plaque, in accordance with City policy, for the Pettit House "Evanleigh".

Attachments