



An agency of the Government of Ontario



Un organisme du gouvernement de l'Ontario

This document was retrieved from the Ontario Heritage Act Register, which is accessible through the website of the Ontario Heritage Trust at **www.heritagetrust.on.ca**.

Ce document est tiré du registre aux fins de la *Loi sur le patrimoine de l'Ontario*, accessible à partir du site Web de la Fiducie du patrimoine ontarien sur **www.heritagetrust.on.ca**.



Corporate Services Department
Legislative Services Division

T. 905.420.4611
TTY. 905.420.1739
F. 905.420.9685
Email clerks@pickering.ca

Pickering Civic Complex
One The Esplanade
Pickering, ON L1V 6K7
Direct 905.420.4660
Toll Free 1.866.683.2760
pickering.ca

ONTARIO HERITAGE TRUST

JUL 12 2013

RECEIVED

July 11, 2013

The Ontario Heritage Foundation
10 Adelaide Street East
Toronto, Ontario M5C 1J3

Subject: 560 Park Crescent – Nesbit-Newman Property
City of Pickering
Designation By-law No. 7290/13
Heritage Designation, Part IV
The Ontario Heritage Act
File: A-3300-001-12

At a meeting held July 8, 2013, the Council of the Corporation of the City of Pickering passed By-law No. 7290/13, a copy of which is enclosed, to designate property municipally known as 560 Park Crescent, Pickering, as a Heritage Structure under Part IV of the Ontario Heritage Act.

A Notice of Passing will be advertised in the July 24, 2013 issue of the newspaper. A copy of the advertisement has been attached for your information.

Further information regarding the designation can be obtained by contacting Debbie Shields, City Clerk at 905.420.4660 ext. 2019.

Yours truly

Debbie Shields
City Clerk
DW/lr
Encl.

Copy: Chief Administrative Officer
Director, City Development

THE CORPORATION OF THE CITY OF PICKERING
IN THE MATTER OF THE *ONTARIO HERITAGE ACT*, R.S.O. 1990, c. 0.18
AND IN THE MATTER OF
LANDS AND PREMISES AT THE FOLLOWING MUNICIPAL ADDRESS
560 PARK CRESCENT, CITY OF PICKERING
PROVINCE OF ONTARIO

NOTICE OF PASSING

TAKE NOTICE that the Council of The Corporation of the City of Pickering has passed By-law #7290/13 to designate the property and building at the following municipal address of historical and architectural value or interest under Part IV of the *Ontario Heritage Act*, R.S.O. 1990, c. 0.18

**Nesbit-Newman Property
560 Park Crescent
Part of Lots 12 & 13, Plan 175
Being Part 1, Plan 40R-27959
Pickering, Ontario**

REASON FOR DESIGNATION OF 560 Park Crescent, Pickering

The subject property is a one-and-a-half-storey, three-bay fieldstone farmhouse built in the mid-1850's in a modified Georgian style. It is located on the west side of Park Crescent, at the western terminus of Surf Avenue, in the City of Pickering's Westshore neighbourhood.

As the only remaining 19th century building in the Westshore neighbourhood and one of very few buildings of this vintage in South Pickering, the Nesbit-Newman House is a visible landmark and a cherished resource in the community.

DATED at the City of Pickering this 24th day of July, 2013

Debbie Shields
City Clerk
City of Pickering
One The Esplanade
Pickering, ON L1V 6K7
Phone: 905.420.4660, ext. 2019

The Corporation of the City of Pickering

By-law No. 7290/13

Being a by-law to designate the lands legally described as that part of Lots 12 & 13, Plan 175, being Part 1, Plan 40R-27959 (the "Nesbit-Newman Property") and municipally known as 560 Park Crescent, City of Pickering, as being of cultural heritage value or interest.

Whereas the *Ontario Heritage Act* authorizes the Council of a municipality to enact a by-law to designate real property, including all buildings and structures thereon, to be of cultural heritage value or interest; and

Whereas on April 16, 2012, Council endorsed the recommendations of its Heritage Advisory Committee to designate the Nesbit-Newman Property as being of cultural heritage value or interest; and

Whereas the reasons for designation are set out in Schedule "A" to this by-law; and

Whereas the Council of The Corporation of the City of Pickering has caused to be served on the owners of the Nesbit-Newman Property and upon the Ontario Heritage Trust, Notice of Intention to designate the property and has caused the Notice of Intention to be published in a newspaper having general circulation in the municipality as required by the *Ontario Heritage Act*; and

Whereas a notice objecting to the proposed designation was received on May 31, 2012, and the objection was withdrawn on April 2, 2013.

Now therefore the Council of The Corporation of the City of Pickering enacts as follows:

1. The Nesbit-Newman Property is designated as being of cultural heritage value or interest for the reasons set out in Schedule "A" attached hereto.
2. The City Solicitor is hereby authorized to cause a copy of this by-law to be registered on title to the Nesbit-Newman Property.
3. The City Clerk is authorized to cause a copy of this by-law to be served upon the owners of the Nesbit-Newman Property and the Ontario Heritage Trust and to publish notice of this by-law in a newspaper having general circulation in the City of Pickering as required by the *Ontario Heritage Act*.

By-law passed this 8th day of July, 2013.



David Ryan, Mayor



Debbie Shields, City Clerk

Schedule "A" to By-law No. 7290/13

Reasons for Designation

Description of Property

The subject property is a one-and-a-half-storey, three-bay fieldstone farmhouse built in the mid-1850s in a modified Georgian style. It is located on the west side of Park Crescent, at the western terminus of Surf Avenue, in the City of Pickering's Westshore neighbourhood.

Statement of Cultural Value or Interest

The Nesbit-Newman House is historically significant as a vestige of the early Scottish settlement surrounding the Village of Dunbarton and for its association with several prominent Pickering citizens. The house was constructed by Peter Nesbit (1808-1896) as part of his "Lakeview" farm in the mid-1850s at a time when Pickering's booming economy prompted residents to build permanent and sturdy homes in place of earlier, sometimes temporary, structures. Nesbit, a native of Haddington, Scotland, was part of an influx of Scottish settlers to Pickering in the 1830s following the arrival of William Dunbar and the development of Dunbarton. A renowned farmer, Nesbit has been described as one of the "worthies" of Dunbarton and contributed a long and distinguished service to the local church. When the new Dunbarton Church (now Dunbarton-Fairport United Church) was constructed in 1886, it was Nesbit who was given the honour of laying the cornerstone. A later resident of the home, Harry A. Newman (1888-1976), also made significant contributions to Pickering's religious community. In 1934, Mr. Newman established St. Paul's on-the-Hill Anglican Church by funding the relocation of a deconsecrated Toronto church to lands that he owned in Pickering along Kingston Road. Mr. Newman remained active in the community throughout his life and served as the first Canadian President of Lions Clubs International and Chairman of the fundraising campaign for the expansion of the Ajax and Pickering General Hospital in 1964. Mr. Newman's son, William G. Newman (1928-1988), is another notable citizen with a connection to the property. William G. Newman served as Reeve of Pickering Township in 1956 at age 27, making him the youngest ever head-of-council in the municipality. He enjoyed a long history in politics as a Member of Provincial Parliament from 1967 to 1981, becoming Minister of Environment in 1974 and Minister of Agriculture and Food in 1975.

The Nesbit-Newman House is architecturally significant in its proportions, unified design, symmetrical balance and general massing as a fine, extant example of an Ontario farmhouse in the vernacular American classical tradition. The ashlar fieldstone masonry of the exterior walls is of a very fine order and the door, window and other exterior details are reflective of the Georgian principles of proportion and symmetry. The house is characterized by a symmetrical centre hall plan and possesses a traditional rear "tail" in this case, a contemporary two-storey addition.

The house is set atop a small raise of land, providing a proud and imposing presence from the street. Its park-like surroundings are key to its history as a farm and the natural spaces immediately surrounding all sides of the building are critical in retaining its pastoral setting. As the only remaining 19th century building in the Westshore neighbourhood and one of very few buildings of this vintage in South Pickering, the Nesbit-Newman House is a visible landmark and a cherished resource in the community.

Description of Heritage Attributes

Key attributes that embody the heritage value of the Nesbit-Newman House include its:

- Historical association with early Scottish settlement near Dunbarton and notable citizens Peter Nesbit, Harry A. Newman and William G. Newman
- Existence as a fine, extant example of a Georgian-inspired Ontario farmhouse
- Rectangular plan with symmetrical three-bay main façade
- Finely crafted ashlar fieldstone masonry with flat-arch voussoirs above all openings
- Medium sloped gable roof
- Stone chimneys centrally located on both gable walls
- Moulded wooden cornice with eave returns on gable walls
- Formal fenestration arrangement with small windows in relation to surface area of stone walls
- 12-over-12 Georgian-style, double-hung windows on the main façade
- Central entrance with well-proportioned transom and truncated sidelights
- Stone cellarway enclosure on the northern elevation
- Two Arts and Crafts-style stone posts bordering the driveway north of the house
- Neatly arranged loose rubble stone pile running parallel to the street at the front of the house
- Setting atop a small raise of land at the terminus of Surf Avenue
- Clear and unobstructed relation to Park Crescent
- Pastoral setting with natural space immediately surrounding all exterior walls
- Status as a visible landmark in the Westshore neighbourhood and South Pickering community

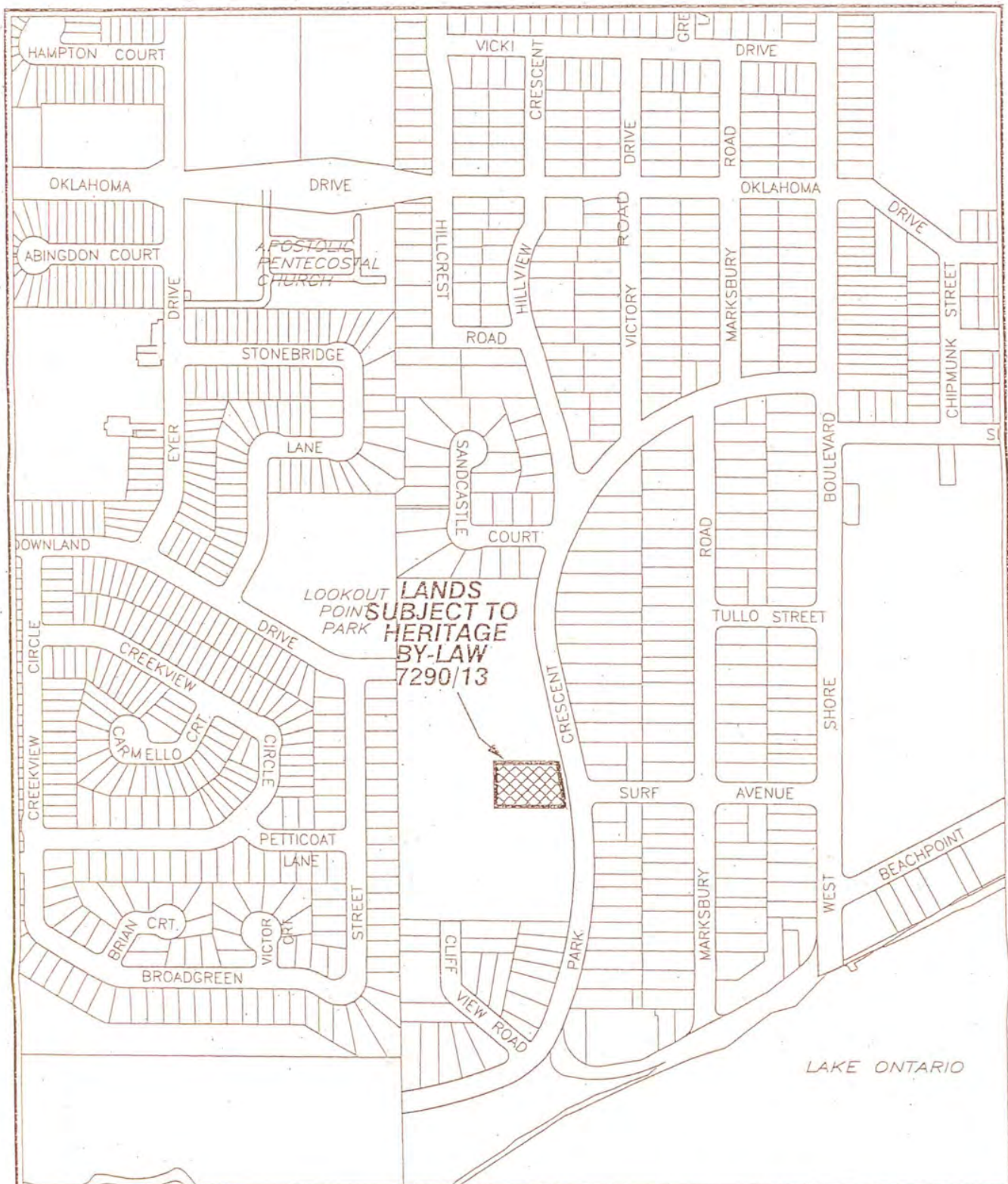

City Development Department

DATE: June 27, 2013

Date Source:
© Teronnet Enterprises Inc. and its suppliers.
All rights Reserved. Not a plan of survey.
© 2013 MPAC and its suppliers.
All rights Reserved. Not a plan of survey.

